



**LEGEND OF PROPOSED FEATURES**

- REGION OF WATERLOO DESIGN GRADES (FILE NO. 7257)
- PROPOSED SPOT ELEVATIONS
- EX = MAINTAIN EXISTING
- T/G = TOP OF CASTING/GRATE
- INV = INVERT ELEVATION
- FFE = FINISHED FLOOR ELEVATION
- DIRECTION OF DRAINAGE/SWALE (RIDGE)
- EMBANKMENT (SLOPE AS NOTED)
- PROPOSED BUILDING
- OVERHEAD DOOR
- MAN DOOR
- CONC. CURB & GUTTER
- RETAINING WALL
- OVERLAND FLOW ROUTE (MAJOR STORM)
- SEDIMENT CONTROL FENCE
- CONSTRUCTION ACCESS
- 100 YEAR PONDING LIMIT (VARIES - REFER TO PLAN)
- 5 YEAR PONDING LIMIT (VARIES - REFER TO PLAN)

**LEGEND OF EXISTING FEATURES**

- SITE BOUNDARY
- EASEMENT
- EXISTING CONTOURS
- EXISTING CURB
- EXISTING FENCE

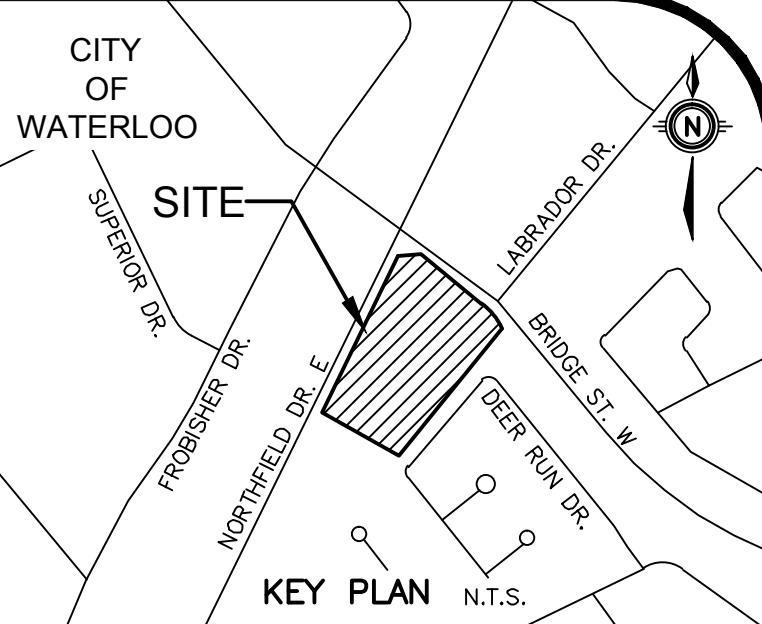

**GEODETCIC BM** ELEV. = 336.361m  
 WA-79 RMW228 3. CITY OF WATERLOO BRASS CAP SET IN CONCRETE IN NORTHWEST CORNER OF WISSLER RD. AND WESTERLY ARM OF DEER RUN DR. 13.9m NORTHWEST OF CENTRELINE OF WISSLER RD. 9.7m SW OF CENTRELINE OF DEER RUN DR. 0.6m NORTHWEST OF CONCRETE SIDEWALK, 0.53m SW OF CONCRETE SIDEWALK, 5cm ABOVE GROUND LEVEL, STAMPED CITY OF WATERLOO 030-85-0025.

**SITE BENCHMARK** ELEV. = 337.274m  
 SB NORTHWEST OF INTERSECTION OF LABORADOR AND BRIDGE STREET WEST

**NOTE TO CONTRACTOR :**  
 DO NOT SCALE DRAWINGS.  
 CONTRACTORS MUST CHECK AND VERIFY ALL DIMENSIONS AND REPORT ANY DISCREPANCIES TO THE ENGINEER BEFORE PROCEEDING WITH THE WORK.  
 ALL DRAWINGS REMAIN THE PROPERTY OF THE ENGINEER AND SHALL NOT BE REPRODUCED OR REUSED WITHOUT THE ENGINEER'S WRITTEN PERMISSION.  
 THE OWNER/ARCHITECT/CONTRACTOR IS ADVISED THAT M.T.E. CONSULTANTS INC. CANNOT CERTIFY ANY COMPONENT OF THE SITE WORKS NOT INSPECTED DURING CONSTRUCTION. IT IS THE RESPONSIBILITY OF THE GENERAL CONTRACTOR TO NOTIFY M.T.E. CONSULTANTS INC. PRIOR TO COMMENCEMENT OF CONSTRUCTION TO ARRANGE FOR INSPECTION.

**NOTE:**  
 1. PROPERTY LINE INFORMATION TAKEN FROM PLAN PREPARED BY AGI SURVEY CONSULTANTS, DATED MAY 27, 2011.

8.			
7.			
6.			
5.			
4.			
3.			
2.			
1.	ISSUED FOR FUNCTIONAL SUBMISSION	RCK	NOV/08/17
No.	REVISION	BY	DATE



(519) 743-6500 www.mte85.com

CLIENT: URBAN LEGEND DEVELOPMENTS LTD.  
 2-25 ABBEY LANE EXETER  
 PROJECT: 255 NORTHFIELD DRIVE EAST WATERLOO

<b>FUNCTIONAL GRADING PLAN II</b>	
Project Manager: R.KERR	Project No: 34780-500
Design By: CAH	Checked By: RCK
Drawn By: PXL	Checked By: CAH
Surveyed By: RLK	Drawing No:
Date: Oct.25/17	<b>C2.2</b>
Scale: 1:300	Sheet 2 of 4