

# 319, 337 & 343 WOOLWICH STREET

## SIGHT LINE REVIEW:

### 1. Stopping Sight Distance – TACC 2017

- It is assumed stopping sight distance governs;
- TACC 2017 provides guidance:

Table 2.5.2: Stopping Sight Distance on level roadways for Automobiles<sup>34</sup>

Design speed (km/h)	Brake reaction distance (m)	Braking distance on level (m)	Stopping sight distance	
			Calculated (m)	Design (m)
20	13.9	4.6	18.5	20
30	20.9	10.3	31.2	35
40	27.8	18.4	46.2	50
50	34.8	28.7	63.5	65
60	41.7	41.3	83.0	85
70	48.7	56.2	104.9	105
80	55.6	73.4	129.0	130
90	62.6	92.9	155.5	160
100	69.5	114.7	184.2	185
110	76.5	138.8	215.3	220
120	83.4	165.2	248.6	250
130	90.4	193.8	284.2	285

### 2. Aerial Photo with Site Plan overlaid



- 3. **Looking westward from Traffic Circle**
  - a. Clear line of sight from Traffic Circle to beyond Lot 5 – distance >65m.



- 4. **Looking southward from Traffic Circle**
  - a. Clear sight distance from Traffic Circle to beyond development limits.



- 5. Looking eastward from near proposed Lot 5**  
- Clear line of sight from Lot 5 to Traffic Circle.



- 6. Looking westward from near proposed Lot 5**  
- Significant sight distance – in excess of 400m.



Lot 5 / 333 Woolwich  
Property Line

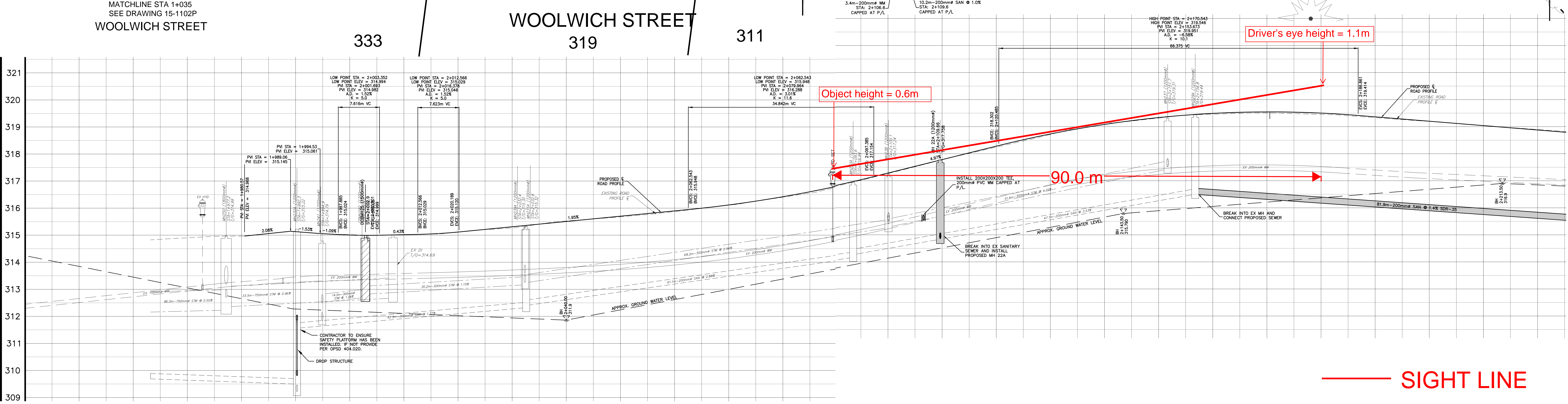
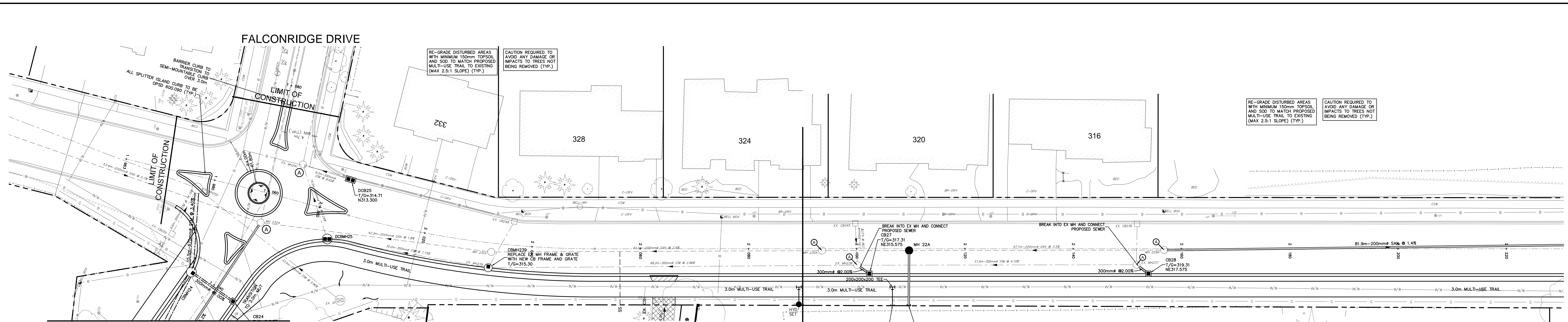

— SIGHT LINE

**SOURCE:**  
Woolwich Street Reconstruction (07/05/16)  
CofW Drawings: 15-1103P & 15-1104P

